

Weekly Construction Progress Report #82

Period: 6/23/13 through 6/29/13

Project Work Performed:

- Continued interim construction survey staking to identify subgrade elevations.
- Continued compliance monitoring including air monitoring, weather monitoring, SWPPP monitoring and fugitive dust monitoring.
- Continued to collect field nuclear density testing to confirm compaction requirements.
- Continued plant slope stabilization activities. Activities will include the removal of loose material from the slope in Area 1 and backfilling Area 3.
- Completed the construction of sump components within the CAT 1 Landfill.
- Continued to screen select protective layer materials to be placed within the CAT I Landfill. Materials will be screened to meet the technical specifications identified within the Construction Quality Assurance Plan (CQAP).
- Continued the installation of the geosynthetic protective layer within the CAT 1 Landfill.
- Began the excavation of anchor trenches along the landfill side PBA slopes in preparation of geosynthetic and ACB installation.

Work Projected Next Week:

- Continue interim construction survey staking to identify subgrade elevations.
- Continue compliance monitoring including air monitoring, weather monitoring, SWPPP monitoring and fugitive dust monitoring.
- Continue plant slope stabilization activities. Activities will include the removal of loose material from the slope in Area 1 and backfilling Area 3.
- Continue to screen select protective layer materials to be placed within the CAT I Landfill. Materials will be screened to meet the technical specifications identified within the Construction Quality Assurance Plan (CQAP).
- Continue the installation of the geosynthetic protective layer within the CAT I Landfill.
- Continue the excavation of anchor trenches along the landfill side PBA slopes in preparation of geosynthetic and ACB installation.
- Site construction activities will be suspended from July 3rd through July 8th in observance of the holiday.

Former ASARCO Smelter Facility

Site Wide Construction Activities

El Paso, TX



Screening select protective layer materials to be placed within the CAT 1 Landfill



Backfill activities within a former plant basement



Plant slope stabilization activities within Area 3

Weekly Construction Progress Report #82 (Continued)

Period: 6/23/13 through 6/29/13

Action Items/Safety:

- Loss Prevention System (LPS) tools
 - Loss Prevention Observation (LPO) – 2 (157)
 - Job Safety Analysis (JSAs) – 0 (10)
 - Near Loss – 0 (10)
 - Minor Equipment Damage – 0 (6)
 - Incidents – 0 (2)
 - Stop Work Authority 0 – (7)

Prepared by EJ Suardini, July 2, 2013



Plant slope stabilization activities within Area 3

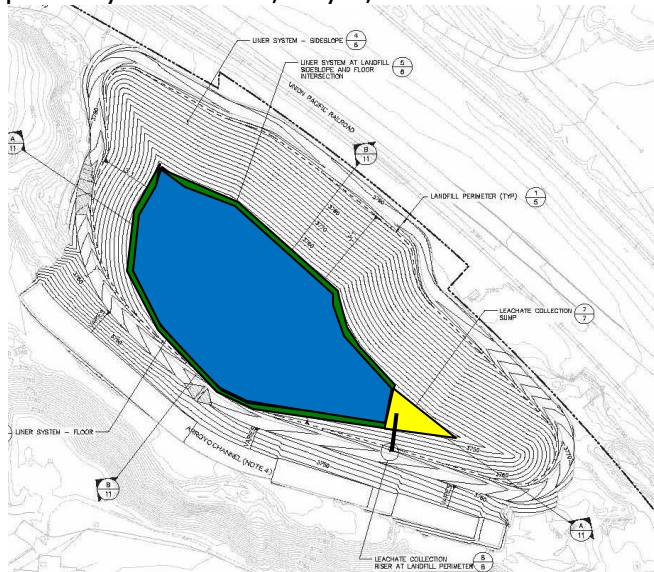

Progress Legend

Red (complete) – Installed 1-foot (2-inch minus) protective cover

Blue - Installed 1-foot (6-inch minus) protective cover

Green – Installed 2-foot (3/8-inch minus) protective cover

Yellow – Installed geotextile, sump aggregate

Estimated Weekly Volume

	Estimated Quantity of CAT II Placement (Tons)	Estimated Quantity of East Borrow Excavation (Tons)	Estimated Quantity of 2-Foot Protective Layer Installed (Tons)	Estimated Quantity of Loose Slag Removed from Area 3 of Plant Slope (Tons)	Estimated Quantity of GCL (Square Feet)	Estimated Quantity of FML (Square Feet)	Estimated Quantity of GDC (Square Feet)
Weekly Total	560	0	2,800	1,040	0	0	0
Total to Date	134,860	41,880	14,180	1,040	207,225	207,225	58,500